



Short Shifter

SAAB NG900, 9-3, 9-5

Installation guide:

1. Remove stock shifter assembly from the car
2. Remove stock shifter from assembly
3. Trace circle inside shifter housing base as on picture :

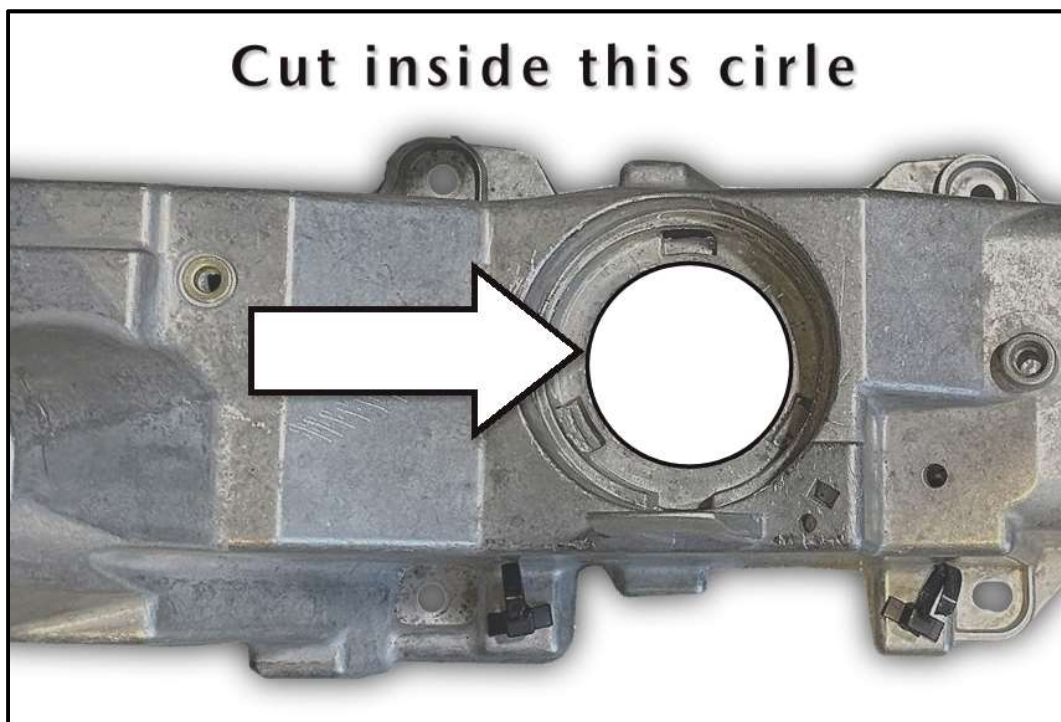

4. Using dremel tool remove material inside the circle and debur all the edges
5. Insert Short Shifter and with 3 bolts. The 3 nuts and washers must grab the edge of grinded circle from below. Hold nuts with pliers from below in order to screw allen bolts from the top of short shifter.
6. Check if nothing obscures Short Shifter movement
7. Reassembly shifter assembly and mount in the car
8. Loosen gear adjustment block (hold down by the 2 allen nuts) and make adjustment until all gears works ok

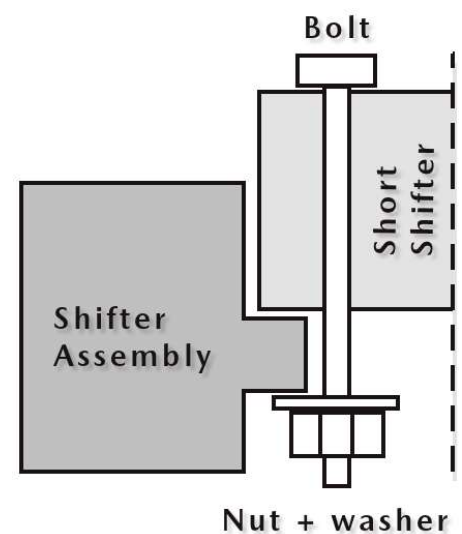

8. Enjoy your new and better shifter !